

# PVC TANK HEADS

TOUGH STUFF® Tank Heads are machined from solid PVC bar stock for maximum reliability in the field. Common applications include DI units, carbon filters and softeners. Tank heads are available in plastics other than PVC, including CPVC, polypropylene, Teflon and PVDF. Please contact your MATTSON/WITT sales representative to discuss custom sizes, configurations and materials.

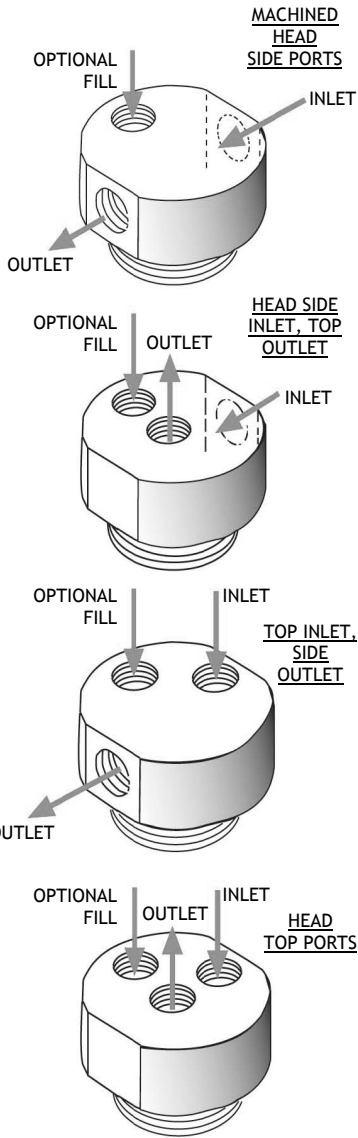

Q8066-1.0A

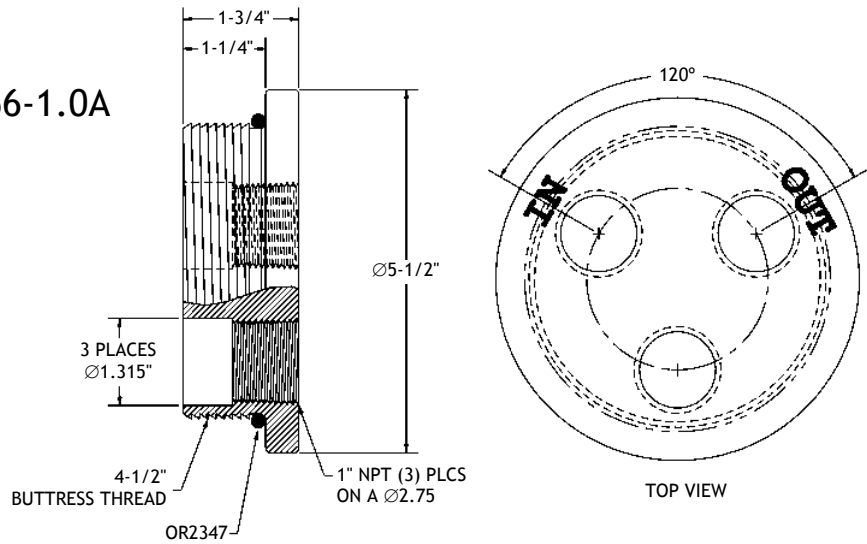

Q8044-1

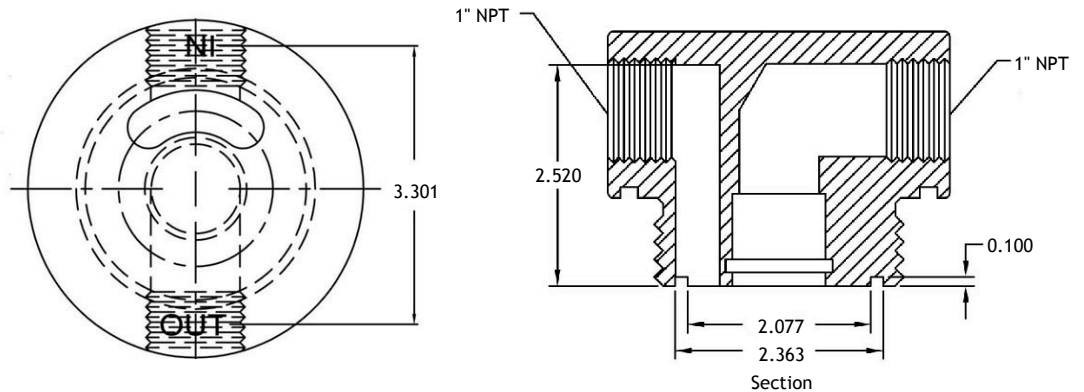

## TECHNICAL SPECIFICATIONS

Maximum recommended operating temperature.....140°F (60°C)  
 Maximum recommended operating pressure ..... 150 PSI  
 Materials.....PVC, Buna-N or EPDM



## STOCKED PVC TANK HEADS

| ITEM        | DESCRIPTION  |
|-------------|--|
| Q8040-.75   | TANK HEAD 2.5" #8X .375" PVC SIDE W/ .75" FILL HOLE & PLUG             |
| Q8042       | TANK HEAD 2.5" #8X .50" PVC SIDE                                       |
| Q8056       | TANK HEAD 2.5" #8X .50" PVC TOP  |
| Q8044       | TANK HEAD 2.5" #8X .75" PVC SIDE                                       |
| Q8044-DS    | TANK HEAD 2.5" #8X .75" PVC SIDE W/ .125" NPT FILL HOLE W/O PLUG       |
| Q8044-.75   | TANK HEAD 2.5" #8X .75" PVC SIDE W/ .75" FILL HOLE & PLUG              |
| Q8044-DS1   | TANK HEAD 2.5" #8X 1.0" PVC SIDE W/ .125" F/ AIR VENT .75" GLUE RISER  |
| Q8044-1     | TANK HEAD 2.5" #8X 1.0" PVC SIDE W/ 1.05" RISER                        |
| Q8044-2     | TANK HEAD 2.5" #8X .75" PVC SIDE W/ .75" FILL HOLE & PLUG/INLET SCREEN |
| Q8044-SS    | TANK HEAD 2.5" #8X SIDE X SIDE FOR FLECK YOKE PVC                      |
| T258375S1PK | TANK HEAD 2.5" #8X .375" I/O SIDE 13/16" RISER MPU I/S (PARK)          |
| Q8048       | TANK HEAD 4.0" #8X 1.0" PVC SIDE                                       |
| Q8048-1.0   | TANK HEAD 4.0" #8X 1.0" PVC SIDE W/ 1.0" FILL HOLE & PLUG              |
| Q8047-1.5   | TANK HEAD 4.0" #8X 1.5" PVC SIDE W/ PEANUT INLET/CENTER RISER O-R      |
| Q8066-1.0A  | TANK HEAD 4.5" PIX1.0" PVC TOP W/ 1.0" FILL, RISER OFFSET              |

